

H2 3023 SERIES

High Pressure, Hydrogen
Pressure Reducing Regulators



Hydrogen regulators from the Premier H2 3023 Series are piston sensed, pressure reducing regulators rated for inlet and outlet pressures up to 15000 PSIG (*1034.21 bar*) and Cv of 0.04, 0.06, 0.12, 0.20, or 0.30.

H2 3023 Series regulators are designed for use in Hydrogen applications; they are available with a wide range of outlet and inlet configurations. Captured venting is standard.

FEATURES

- Designed for use with Hydrogen
- 15000 PSIG (*1034.21 bar*) MAX
- Captured venting standard
- Cv 0.04, 0.06, 0.12, 0.20, or 0.30
- Numerous optional features
- Toughmet® 3 TS160U Alloy valve actuator stem
- Economical pricing
- Machined bar stock body, bonnet and piston eliminates porosity found in castings

SOME APPLICATIONS WILL REQUIRE A CUSTOM SOLUTION.
CONTACT PREMIER INDUSTRIES TO REQUEST A MODIFICATION
OR A CUSTOM DESIGN.

SPECIFICATIONS

- **MAX INLET PRESSURE:**
 - REGULATOR: 15000 PSIG (1034.21 bar)
- **OUTLET PRESSURE RANGES:**
 - 5-500 PSIG (0.34 - 34.47 bar),
 - 5-1000 PSIG (0.34 - 68.95 bar),
 - 10-1500 PSIG (0.69 - 103.42 bar),
 - 15-2500 PSIG (1.03 - 172.37 bar),
 - 25-4000 PSIG (1.72 - 275.79 bar),
 - 50-6000 PSIG (3.45 - 413.69 bar),
 - 100-10000 PSIG (6.89 - 689.48 bar),
 - 300-15000 PSIG (20.68 - 1034.21 bar)
- **FLOW (Cv):** 0.04, 0.06, 0.12, 0.20, 0.30
- **VENT VALVE Cv:** 0.06
- **OPERATING TEMPERATURE:**
 - -15°F/-26°C to 165°F/74°C (BUNA-N)
 - -4°F/-20°C to 165°F/74°C (VITON®)
 - -65°F/-54°C to 165°F/74°C (EPDM)

PORTING

- **INLET/OUTLET PORTING OPTIONS:**
 - 1/4", 3/8" FNPT (standard)
 - 1/4", 3/8", 9/16" Medium Pressure
 - 1/4", 3/8" High Pressure
- **VENT PORT:** 1/4" inlet/outlet port type

OPTIONS

- Surface mount
- Private label
- Ball bearing loader
- Panel mounting bracket: P/N: 30-10059
(Ø2.15 panel hole)

MATERIALS OF CONSTRUCTION

- **BODY:**
 - 316 Stainless Steel
- **VALVE ACTUATOR STEM:**
 - Toughmet® 3 TS160U Alloy
- **WETTED PARTS, OTHER:**
 - 316 Stainless Steel
- **O-RING OPTIONS:**
 - Buna-N
 - Viton®
 - EPDM
- **BACK-UP RINGS:** PTFE, PCTFE
- **MAIN VALVE SEAT/VENT VALVE SEAT:**
 - Vespel®

Vespel® & Viton® are registered trademarks of E.I.duPont de Nemours and Company

ToughMet® is a registered trademark of Materion Brush Inc.

Contact factory for material certifications. Fees may apply.

PART NUMBER: H30-10213

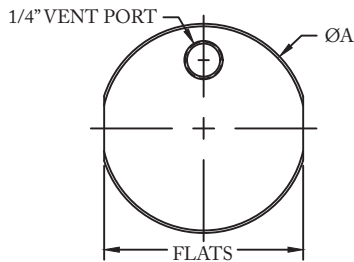
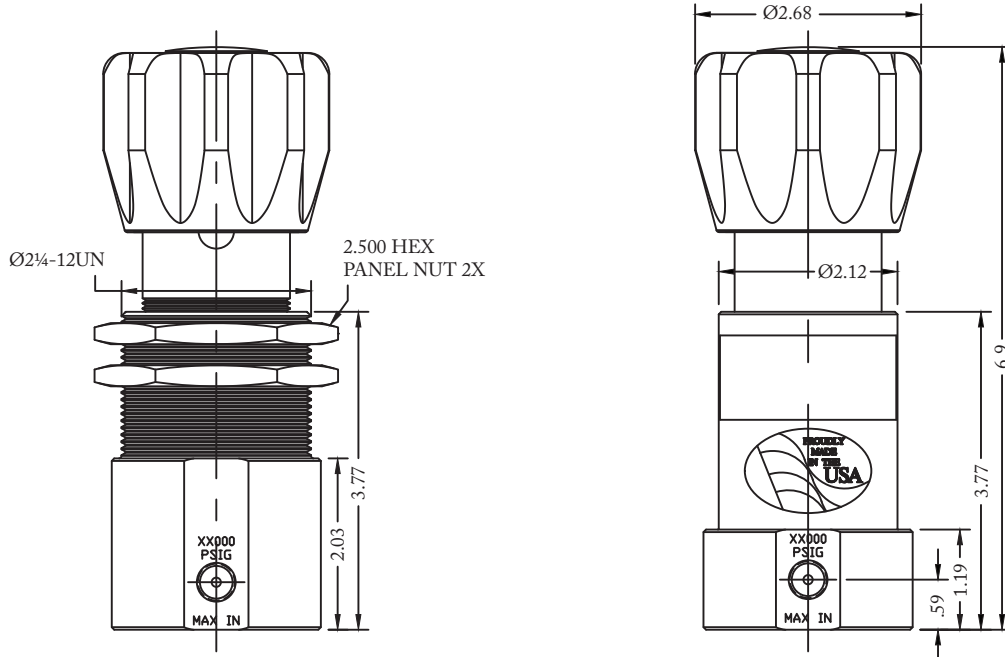

**BALL-BEARING LOADER
W/ OVERSIZED KNOB**

**ACORN NUT-
TAMPER RESISTANT**

PORT TYPE	ØA	FLATS
NPT	Ø2.48	—
1/4" OTHER	Ø2.48	2.36
3/8" M.P.	Ø2.98	2.81
3/8" H.P.	Ø3.23	2.98
9/16" M.P.	Ø3.23	2.98

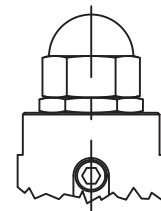
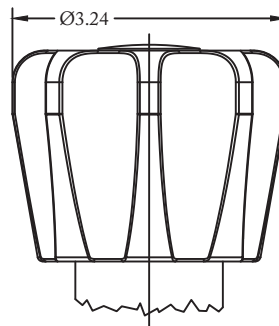

SERIES	1	2	-	3	4	5	6	7	-	8	9	-	MODS
H30-10213			-						-			-	

1 2	MOUNTING STYLE
MB	Mounting bracket style body
PN	Panel nut style body
3	OUTLET PRESSURE
1	5-500 PSIG / 0.34-34.5 Bar
2	5-1000 PSIG / 0.34-68.9 Bar
3	10-1500 PSIG / 0.69-103.4 Bar
4	15-2500 PSIG / 1.0-172.4 Bar
5	25-4000 PSIG / 1.7-275.8 Bar
6	50-6000 PSIG / 3.4-413.7 Bar
7	100-10000 PSIG / 6.9-689.5 Bar
8	300-15000 PSIG / 20.68-1034.21 Bar
4	Cv RATING
A	0.04
0	0.06
1	0.12
2	0.20
3	0.30

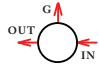
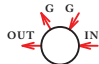
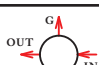
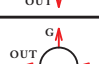
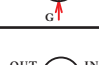
5	PORTING CONFIG.
A	
C	
E	
L	
S	
6	PORT SIZE
4	1/4"
6	3/8"
9	9/16" (only available in medium pressure)
<i>VENT PORT: 1/4" inlet/outlet port type GAUGE PORTS: 1/4" FNPT</i>	
7	PORT TYPE
1	FNPT
4	Medium Pressure
5	High Pressure

8 9	O-RINGS
00	BUNA-N
02	VITON®
05	EPDM
MODIFICATIONS	
<i>Separate multiple mods with a dash</i>	
Blank	None
ANT	Acorn nut
BBL	Ball-bearing loader
NV	Non-venting
PTU	Port type uniform
SM	Surface mount*
<i>*SURFACE MOUNT: pattern dependent on port type, size, & configuration. - not available on panel mount style bodies</i>	

15000 PSIG MAX INLET
The end user is responsible to ensure adequate fittings are used to connect regulator to plumbing

Viton® is a registered trademark of E.I.duPont de Nemours and Company.

Contact factory for material certifications. Fees may apply.