

O2 3023 SERIES

High Pressure, Oxygen
Pressure Reducing Regulators



Premier O2 3023 Series pressure reducing regulators are single stage, piston sensed, variable delivery, pressure reducing regulators, designed for inlet and outlet pressures up to 15000 PSIG (*1034.21 bar*) and Cv 0.04 or 0.06.

Premier 3023 Series regulators are designed for use in Oxygen applications; they are available with a wide range of inlet and outlet configurations. Captured venting is standard.

FEATURES

- Designed for use with Oxygen
- Captured venting
- 15000 PSIG (*1034.21 bar*) MAX
- Cv 0.04 or 0.06
- Numerous optional features
- Economical pricing
- Machined bar stock body, bonnet and piston eliminates porosity found in castings

SOME APPLICATIONS WILL REQUIRE A CUSTOM SOLUTION.
CONTACT PREMIER INDUSTRIES TO REQUEST A MODIFICATION
OR A CUSTOM DESIGN.

SPECIFICATIONS

- **MAX INLET PRESSURE (SS):**
 - 15000 PSIG (1034.21 bar)
- **CONTROL PRESSURE RANGES:**
 - 5-500 PSIG (0.34 - 34.47 bar),
 - 5-1000 PSIG (0.34 - 68.95 bar),
 - 10-1500 PSIG (0.69 - 103.42 bar),
 - 15-2500 PSIG (1.03 - 172.37 bar),
 - 25-4000 PSIG (1.72 - 275.79 bar),
 - 50-6000 PSIG (3.45 - 413.69 bar),
 - 100-10000 PSIG (6.89 - 689.48 bar),
 - 300-15000 PSIG (20.68 - 1034.21 bar)
- **FLOW (Cv):** 0.04, or 0.06
- **VENT VALVE (Cv):** 0.06
- **OPERATING TEMPERATURE:**
 - -4°F/-20°C to 165°F/74°C (VITON®)

MATERIALS OF CONSTRUCTION

- **BODY:** Monel® 400
- **VALVE ACTUATOR:** Monel® K-500
- **VALVE SPRING:** Monel® 400
- **WETTED PARTS, OTHER:**
 - Monel® 400
- **O-RING MATERIAL OPTIONS:**
 - Viton®-A
 - Kalrez®
- **BACK-UP RINGS:**
 - PTFE
 - PCTFE
- **MAIN VALVE SEAT:** Vespel® SP-21
- **VENT VALVE SEAT:** Vespel® SP-21
- **INLET FILTER:** Sintered bronze, 15 micron
- **NON-WETTED:**
 - 303 Stainless Steel
 - 17-4 Stainless Steel
 - Spring steel
 - Aluminum

PORTING

- **INLET/OUTLET PORTS:**
 - 1/4" FNPT (*standard*), medium pressure, high pressure
 - 3/8" FNPT, medium pressure, high pressure
 - 9/16" medium pressure
- **VENT PORT:**
 - 1/4" FNPT
 - 1/4" Medium pressure
 - 1/4" High pressure
- **OPTIONAL GAUGE PORTS:** 1/4" FNPT

OPTIONS

- Gauges
- Private label
- Panel mounting bracket: P/N: 30-10059 (Ø2.15 panel hole)
- Panel mounting nuts: P/N: 30-10189 (Ø2.28 panel hole)
- Tamper resistant acorn nut
- Ball-bearing loader

Vespel®, Viton®, and Kalrez® are registered trademarks of E.I. duPont de Nemours and Company

Contact factory for material certifications. Fees may apply.

PART NUMBER: Oy30-10213

**PANEL NUT
STYLE**

**PANEL MOUNTING
BRACKET STYLE**

**OPTIONAL
BALL BEARING LOADER**

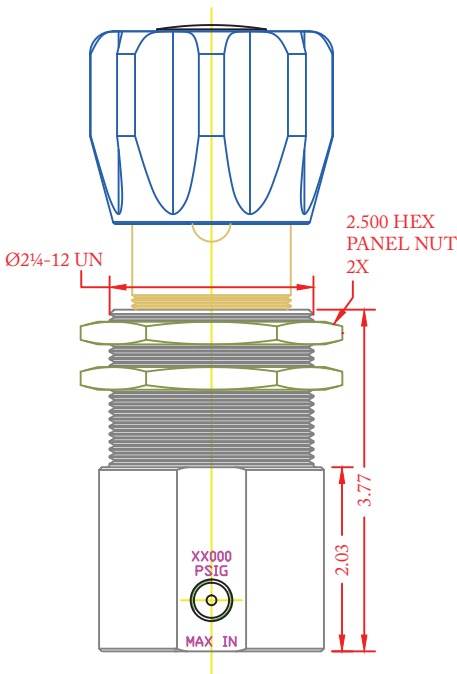

2.500 HEX
PANEL NUT
2X

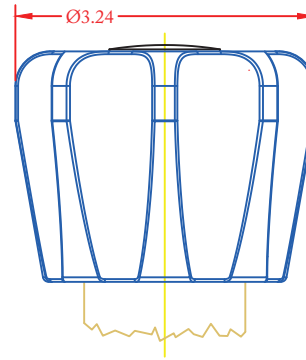
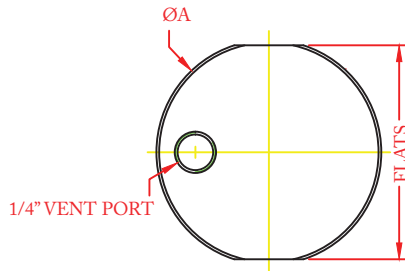
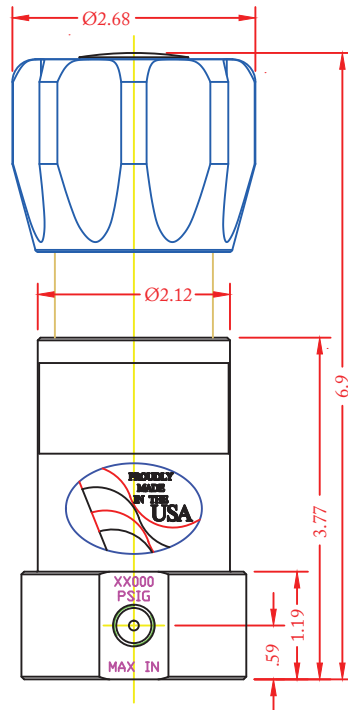

**OPTIONAL
TAMPER RESISTANT
ACORN NUT**

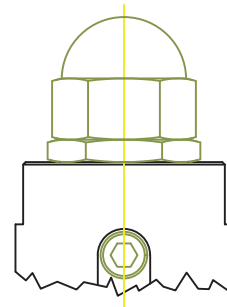

PORT TYPE	ØA	FLATS
NPT	Ø2.48	—
1/4" OTHER	Ø2.48	2.36
3/8" M.P.	Ø2.98	2.81
3/8" H.P.	Ø3.23	2.98
9/16" M.P.	Ø3.23	2.98

O2 3023 SERIES



High Pressure, Oxygen
Pressure Reducing Regulators

SERIES	1	2	-	3	4	5	6	7	-	8	9	-	MODS
Oy30-10213			-						-			-	

15000 PSIG MAX INLET

VESPEL® SP-21 MAIN VALVE SEAT

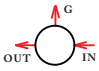
1 2	MOUNTING STYLE
MB	Mounting bracket style body
PN	Panel nut style body
3	OUTLET PRESSURE
1	5-500 PSIG / 0.34-34.5 Bar
2	5-1000 PSIG / 0.34-68.9 Bar
3	10-1500 PSIG / 0.69-103.4 Bar
4	15-2500 PSIG / 1.0-172.4 Bar
5	25-4000 PSIG / 1.7-275.8 Bar
6	50-6000 PSIG / 3.4-413.7 Bar
7	100-10000 PSIG / 6.9-689.5 Bar
8	300-15000 PSIG / 20.68-1034.21 Bar
4	FLOW (Cv)
1	0.04 Cv
2	0.06 Cv
<i>VENT VALVE: Cv 0.06</i>	

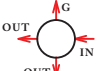
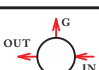
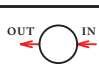
5	PORTING CONFIG.
A	
C	
E	
L	
S	
6	PORT SIZE
4	1/4"
6	3/8"
9	9/16" (only available in medium pressure)
<i>GAUGE PORTS: 1/4" FNPT (unless PTU mod is selected)</i>	
<i>VENT PORT: 1/4" inlet/outlet port type</i>	
7	PORT TYPE (INLET/OUTLET/VENT)
1	FNPT
4	Medium Pressure
5	High Pressure

8 9	O-RINGS
02	VITON®
11	KALREZ <i>(contact factory for pricing)</i>
MODIFICATIONS	
<i>Separate multiple mods with a dash</i>	
BLANK	None
ANT	Acorn nut
BBL	Ball-bearing loader
PTU	Port type uniform
SM	Surface mount
VP1	1/4" NPT vent port

15000 PSIG MAX INLET

The end user is responsible to ensure adequate fittings are used to connect regulator to plumbing

Kalrez® & Viton® are registered trademarks of E.I. duPont de Nemours and Company.

Contact factory for material certifications. Fees may apply.