

6023 SERIES

High Pressure, Hydraulic, 15000 PSIG
Pressure Reducing Regulators



The high pressure, hydraulic Premier 6023 Series pressure reducing regulators are single stage, piston sensed, variable delivery, pressure reducing regulators, designed for inlet and outlet pressures up to 15000 PSIG (*1034.21 bar*) and Cv 0.06, 0.12, or 0.20.

Premier 6023 Series regulators are used to regulate a broad range of non-corrosive and corrosive media (based on materials of construction). The regulator's captured venting allows fluids/gases to be safely piped away. Premier 6023 Series regulators can be supplied with a wide range of inlet and outlet configurations.

FEATURES

- Captured venting
- 15000 PSIG (*1034.21 bar*) MAX
- Cv 0.06, 0.12, or 0.20
- Optional ball-bearing loader
- Optional tamper resistant acorn nut
- Optional threaded panel mounting nut or panel mounting bracket style body
- Economical pricing
- Machined bar stock body, bonnet and piston eliminates porosity found in castings

SOME APPLICATIONS WILL REQUIRE A CUSTOM SOLUTION.
CONTACT PREMIER INDUSTRIES TO REQUEST A MODIFICATION
OR A CUSTOM DESIGN.

SPECIFICATIONS

- **MAX INLET PRESSURE (SS):**
 - 15000 PSIG (1034.21 bar)
- **CONTROL PRESSURE RANGES:**
 - 5-500 PSIG (0.34 - 34.47 bar),
 - 5-1000 PSIG (0.34 - 68.95 bar),
 - 10-1500 PSIG (0.69 - 103.42 bar),
 - 15-2500 PSIG (1.03 - 172.37 bar),
 - 25-4000 PSIG (1.72 - 275.79 bar),
 - 50-6000 PSIG (3.45 - 413.69 bar),
 - 100-10000 PSIG (6.89 - 689.48 bar),
 - 300-15000 PSIG (20.68 - 1034.21 bar)
- **FLOW (Cv):** 0.06, 0.12, 0.20
- **VENT VALVE (Cv):** 0.06,
- **OPERATING TEMPERATURE:**
 - -15°F/-26°C to 165°F/74°C (BUNA-N)
 - -4°F/-20°C to 165°F/74°C (VITON®)
 - -65°F/-54°C to 165°F/74°C (EPDM)
 - 15°F/-9°C to 165°F/74°C (AFLAS®)
 - -65°F/-54°C to 165°F/74°C (NITRILE)

MATERIALS OF CONSTRUCTION

- **BODY:** 316 Stainless Steel,
- **BONNET:** 17-4 Stainless Steel
- **WETTED PARTS, OTHER:**
 - 316 Stainless Steel,
 - 17-4 Stainless Steel
- **BACK-UP RINGS:** PTFE, PCTFE
- **MAIN VALVE SEAT OPTIONS:**
 - 316 Stainless Steel
 - Vespel®
- **MAIN/VENT VALVE STEM:**
 - 17-4 Stainless Steel
- **VENT VALVE SEAT:**
 - Vespel®
 - 316 Stainless Steel
- **STANDARD LUBRICANT:**
 - Krytox® GPL 206

Vespel® and Viton® are registered trademarks of E.I. duPont de Nemours and Company

AFLAS® is a registered trademark of Asahi Glass Co., Ltd

Krytox® is a registered trademark of e Chemours Company FC, LLC.

PORTING

- **INLET/OUTLET PORTS:**
 - 1/4" FNPT (standard), medium pressure, high pressure
 - 3/8" FNPT, medium pressure, high pressure
 - 9/16" medium pressure
- **VENT PORT:**
 - 1/4" inlet/outlet port type
- **GAUGE PORTS:** 1/4" FNPT

OPTIONS

- Gauges
- Private label
- Panel mounting bracket: P/N: 30-10059 (Ø2.15 panel hole)
- Panel mounting nuts: P/N: 30-10189 (Ø2.28 panel hole)

PART NUMBER: 30-10213

PANEL NUT STYLE

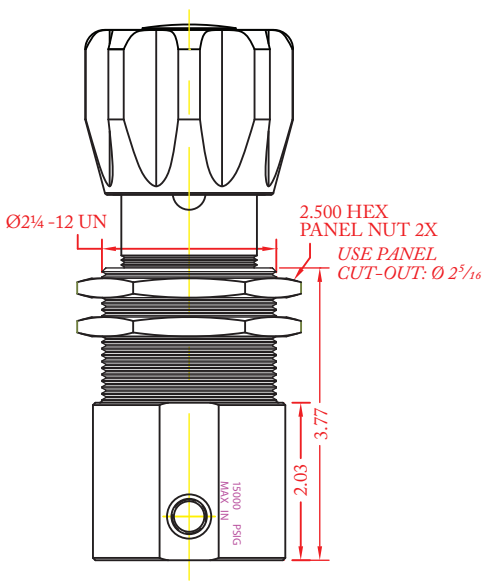

PANEL MOUNTING BRACKET STYLE

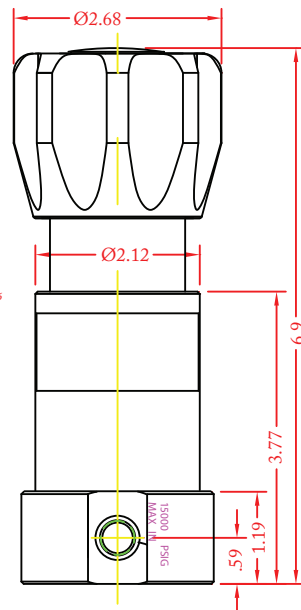

TAMPER RESISTANT ACORN NUT (optional)

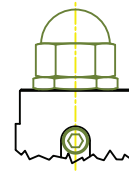

BALL BEARING LOADER (optional)

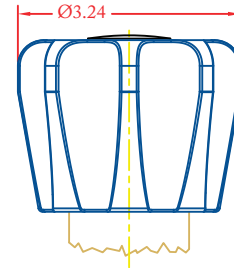

PORT TYPE	ØA	FLATS
NPT	Ø2.48	—
1/4" OTHER	Ø2.48	2.36
3/8" M.P.	Ø2.98	2.81
3/8" H.P.	Ø3.23	2.98
9/16" M.P.	Ø3.23	2.98

3/8" and larger 'L' and 'E' porting configurations require a larger ØA

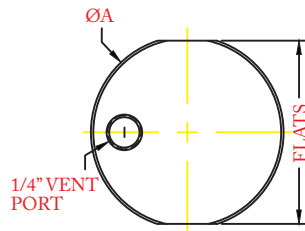



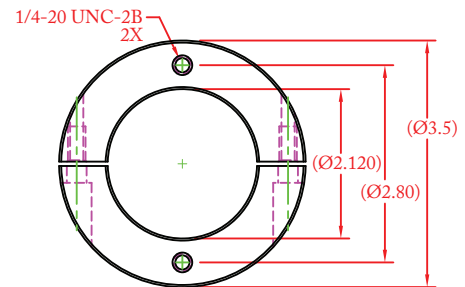

PANEL MOUNTING BRACKET (optional)

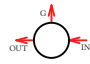

PART #	1	2	-	3	4	5	6	-	7	8	9	-	MODS
30-10213			-					-				-	

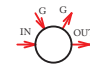
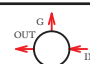
1 2	MOUNTING STYLE
MB	MOUNTING BRACKET STYLE BODY
PN	PANEL NUT STYLE BODY
3	OUTLET PRESSURE
1	5-500 PSIG (0.34-34.5 Bar)
2	5-1000 PSIG (0.34-68.95 Bar)
3	10-1500 PSIG (0.69-103.4 Bar)
4	15-2500 PSIG (1.0-172.4 Bar)
5	25-4000 PSIG (1.7-275.8 Bar)
6	50-6000 PSIG (3.4-413.7 Bar)
7	100-10000 PSIG (6.9-689.5 Bar)
8	300-15000 PSIG (20.68-1,034.21 Bar)

4	PORTING CONFIG.
A	
C	
D	
E*	
L*	
S	

*L and E porting configurations w/ 3/8" ports and larger require a larger body diameter

5	PORT SIZE
4	1/4"
6	3/8"
9	9/16" (only available in medium pressure)
6	PORT TYPE IN/OUT/VENT
1	FNPT
4	MEDIUM PRESSURE
5	HIGH PRESSURE

GAUGE PORTS: 1/4" FNPT
VENT PORT: 1/4" inlet/outlet type

7 8	O-RINGS
00	BUNA-N
01	AFLAS®
02	VITON®
05	EPDM
08	POLYURETHANE
11	FFKM <i>(Contact Premier for pricing)</i>
12	NITRILE, LO-TEMP
9	Cv MAIN VALVE (VALVE SEAT MATERIAL)
0	Cv 0.06 (Vespel®)
1	Cv 0.12 (Vespel®)
2	Cv 0.20 (Vespel® SCP-5000)
5	Cv 0.06 (316 Stainless Steel)
6	Cv 0.12 (316 Stainless Steel)
7	Cv 0.20 (316 Stainless Steel)
MODIFICATIONS	
<i>Separate multiple mods with a dash</i>	
BLANK	None
AC	Krytox 240AC
ANT	Acorn nut
BBL	Ball-bearing loader
G1	Gauges
PTU	Port type uniform
VP1	NPT vent port

Vespel® & Viton® are registered trademarks of E.I. duPont de Nemours and Company
AFLAS® is a registered trademark of Asahi Glass Co., Ltd

15000 PSIG MAX INLET
The end user is responsible to ensure adequate fittings are used to connect regulator to
Contact factory for material certifications. Fees may apply.