

3023 SERIES

High Pressure, Piston Sensed
Pressure Reducing Regulators



The Premier 3023 Series high pressure pressure reducing regulators are single-stage, piston-sensed, variable-delivery regulators rated for inlet and outlet pressures up to 15000 PSIG (1034.21 BAR), with standard Cv values of 0.06, 0.12, or 0.20.

An optional large-sensor configuration with Cv 0.04 provides enhanced sensitivity and improved control at lower outlet pressure ranges, making it well suited for applications requiring precise low-pressure regulation while maintaining high inlet pressure capability.

The Premier 3023 Series is suitable for a wide range of non-corrosive and corrosive media, based on the selected materials of construction. Captured venting allows media to be safely piped away for use in enclosed or controlled environments. A broad selection of inlet and outlet configurations supports seamless integration into high-pressure systems.

FEATURES

- Captured venting (*optional non-venting modification available*)
- 15000 PSIG (*1034.21 BAR*) MAX
- Cv 0.06, 0.12, or 0.20
- Optional large-sensor configuration (Cv 0.04)
- Made in the USA
- Machined bar stock body, bonnet and piston eliminates porosity found in castings

SOME APPLICATIONS WILL REQUIRE A CUSTOM SOLUTION.
CONTACT PREMIER INDUSTRIES TO REQUEST A MODIFICATION
OR A CUSTOM DESIGN.

SPECIFICATIONS

- **MAX INLET PRESSURE (SS):**
 - 15000 PSIG (1034.2 BAR)
- **OUTLET PRESSURE RANGES:**
 - P/N 30-10213LS:**
 - 40–200 PSIG (2.8–13.8 BAR)
 - 40–300 PSIG (2.8–20.7 BAR)
 - 40–600 PSIG (2.8–41.4 BAR)
 - P/N 30-10213G:**
 - 50–500 PSIG (3.4–34.5 BAR)
 - 100–1000 PSIG (6.9–68.9 BAR)
 - 150–1500 PSIG (10.3–103.4 BAR)
 - 250–2500 PSIG (17.2–172.4 BAR)
 - 400–4000 PSIG (27.6–275.8 BAR)
 - 600–6000 PSIG (41.4–413.7 BAR)
 - 1000–10000 PSIG (68.9–689.5 BAR)
 - 1500–15000 PSIG (103–1034 BAR)
- **FLOW (C_v):**
 - P/N: 30-10213G: 0.06, 0.12, or 0.20
 - P/N: 30-10213LS: 0.04
- **VENT VALVE (C_v):** 0.06
- **OPERATING TEMPERATURE:**
 - -15°F/-26°C to 165°F/74°C (BUNA-N)
 - -4°F/-20°C to 165°F/74°C (VITON®)
 - -65°F/-54°C to 165°F/74°C (EPDM)
 - 15°F/-9°C to 165°F/74°C (AFLAS)

MATERIALS OF CONSTRUCTION

- **BODY:** 316 Stainless Steel,
- **BONNET:** 17-4 Stainless Steel
- **MAIN/VENT VALVE STEM:**
 - 17-4 Stainless Steel
- **WETTED PARTS, OTHER:**
 - 316 Stainless Steel,
 - 17-4 Stainless Steel
- **BACK-UP RINGS:**
 - PTFE
 - PCTFE
- **VALVE SEAT:** Vespel®
- **STANDARD LUBRICANT:**
 - Krytox® GPL 206

PORTING

- **INLET/OUTLET/**
 - 1/4" FNPT (*standard*), medium pressure, high pressure
 - 3/8" FNPT, medium pressure, high pressure
 - 9/16" medium pressure
- **VENT PORTING:**
 - 1/4" FNPT (*standard*)
 - 1/4" Medium pressure
 - 1/4" High pressure
- **GAUGE PORTS:** 1/4" FNPT

OPTIONS

- Gauges
- Private label
- Panel mounting bracket:
 - P/N: 30-10213G: P/N: 30-10059 (Ø2.15 panel cut out)
 - P/N: 30-10213LS: P/N: 30-10500 (Ø2.56 panel cut out)
- Panel mounting nuts: P/N: 30-10189 (Ø2.28 panel cut out)
- Non-venting modification
- Tamper resistant acorn nut
- Ball-bearing loader

Vespel® & Viton® are registered trademarks of E.I. duPont de Nemours and Company

Krytox® is a registered trademark of e Chemours Company FC, LLC.

Contact factory for material certifications. Fees may apply.

PART NUMBER: 30-10213G

PANEL NUT STYLE

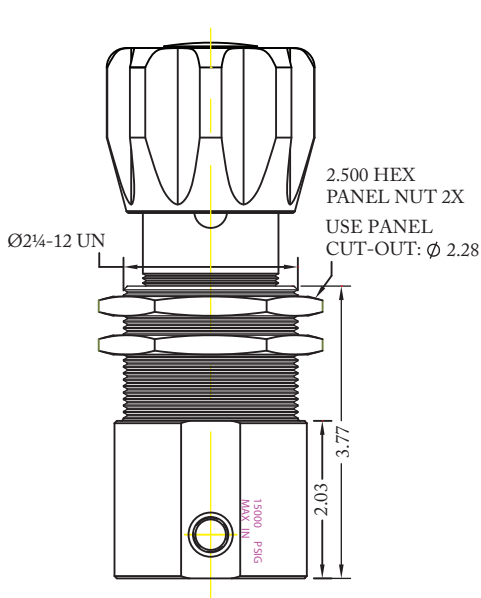

PANEL MOUNTING BRACKET STYLE

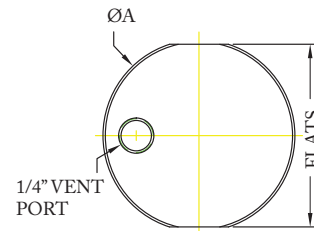
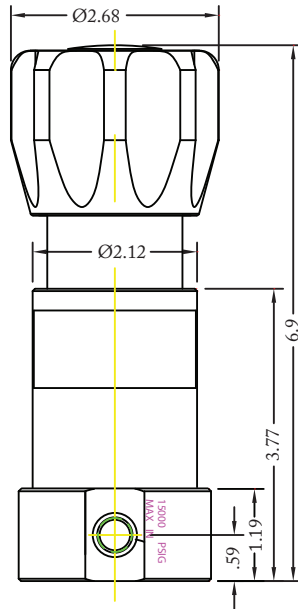

PORT TYPE	ϕ BODY	FLATS
NPT	ϕ 2.48	—
1/4" OTHER	ϕ 2.48	2.36
3/8" M.P.	ϕ 2.98	2.81
3/8" H.P.	ϕ 3.23	2.98
9/16" M.P.	ϕ 3.23	2.98

PART NUMBER: 30-10213LS

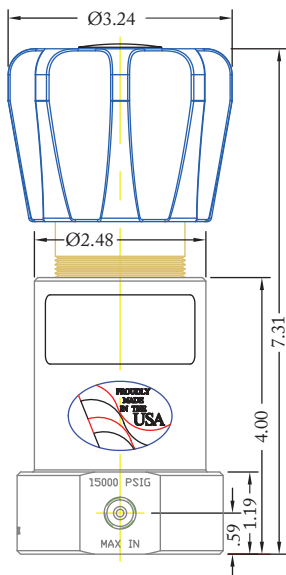

#10-32 UNF SURFACE
MOUNT HOLES
(OPTIONAL)

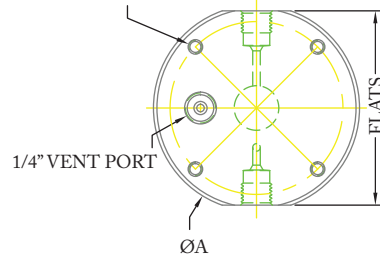

PORT TYPE	ϕ BODY	FLATS
NPT	ϕ 2.98	—
1/4" M.P. & H.P.	ϕ 2.98	2.81
3/8" M.P.	ϕ 2.98	2.81
3/8" H.P.	ϕ 3.23	2.98
9/16" M.P.	ϕ 3.48	3.20

PANEL MOUNTING BRACKET

P/N: 30-10059

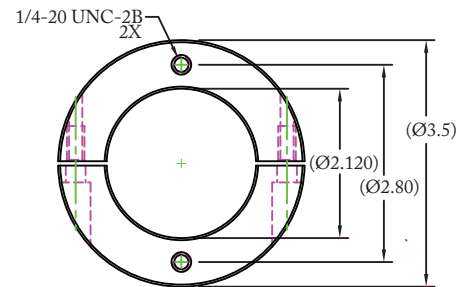



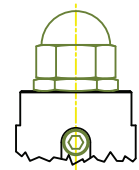
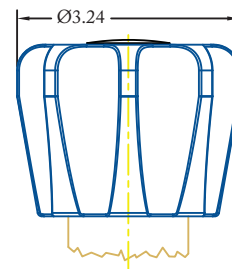

OPTIONAL BALL BEARING LOADER OR TAMPER RESISTANT ACORN NUT

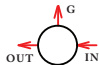

SERIES	1	2	-	3	4	5	6	-	7	8	9	-	MODS
30-10213G			-					-				-	

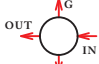
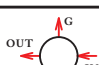
1 2	MOUNTING STYLE
MB	MOUNTING BRACKET STYLE BODY
PN	PANEL NUT STYLE BODY
3	OUTLET PRESSURE
1	5-500 PSIG / 0.34-34.5 BAR
2	5-1000 PSIG / 0.34-68.9 BAR
3	10-1500 PSIG / 0.69-103.4 BAR
4	15-2500 PSIG / 1.0-172.4 BAR
5	25-4000 PSIG / 1.7-275.8 BAR
6	50-6000 PSIG / 3.4-413.7 BAR
7	100-10000 PSIG / 6.9-689.5 BAR
8	300-15000 PSIG / 20.68-1034.21 BAR

4	PORTING CONFIG.
A	
C	
D	
E	
L	
S	
5	PORT SIZE
4	1/4"
6	3/8"
9	9/16" (ONLY AVAILABLE IN MEDIUM PRESSURE)
GAUGE PORTS: 1/4" FNPT	
VENT PORT: 1/4" INLET/OUTLET PORT TYPE	
6	PORT TYPE (INLET/OUTLET)
1	FNPT
4	MEDIUM PRESSURE
5	HIGH PRESSURE

7 8	O-RINGS
00	BUNA-N
01	AFLAS®
02	VITON®
05	EPDM
08	POLYURETHANE
11	FFKM <i>(CONTACT PREMIER FOR PRICING)</i>
12	NITRILE, LO-TEMP
9	Cv MAIN VALVE VALVE SEAT MATERIAL
0	Cv 0.06 VESPEL SP-1®
1	Cv 0.12 VESPEL SP-1®
2	Cv 0.20 VESPEL SCP-5000®
VENT VALVE: Cv 0.06	
MODIFICATIONS	
<i>SEPARATE MULTIPLE MODS WITH A DASH</i>	
Blank	NONE
AC	KRYTOX 240AC
ANT	ACORN NUT
BBL	BALL-BEARING LOADER
G1	GAUGES
NV	NON-VENTING
PTU	PORT TYPE UNIFORM
VP1	1/4" FNPT VENT PORT

15000 PSIG MAX INLET
THE END USER IS RESPONSIBLE TO ENSURE
ADEQUATE FITTINGS ARE USED TO CONNECT
REGULATOR TO PLUMBING

VESPEL® & VITON® ARE REGISTERED TRADEMARKS
OF E.I. DUPONT DE NEMOURS AND COMPANY. AFLAS®
IS A REGISTERED TRADEMARK OF THE ASAHI GLASS
CO., LTD

CONTACT FACTORY FOR MATERIAL CERTIFICATIONS.
FEES MAY APPLY.

SERIES	1	2	-	3	4	5	6	-	7	8	9	-	MODS
30-10213			-					-				-	

LARGE SENSOR

Cv 0.04

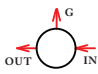
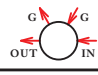
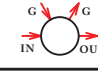
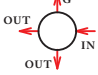
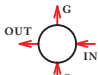
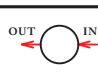
1 2	SENSOR SIZE
LS	LARGE SENSOR, Ø1.50, HIGH SENSITIVITY
3	OUTLET PRESSURE
2	40-200 PSIG / 2.8-13.8 BAR(G)
3	40-300 PSIG / 2.8-20.7 BAR(G)
6	40-600 PSIG / 2.8-41.4 BAR(G)
4	PORTING CONFIGURATION
A	
C	
D	
E	
L	
S	

5	PORT SIZE
4	1/4"
6	3/8"
9	9/16" (<i>ONLY AVAILABLE IN MEDIUM PRESSURE</i>)
<i>GAUGE PORTS: 1/4" FNPT</i>	
<i>VENT PORT: 1/4" INLET/OUTLET PORT TYPE</i>	
6	PORT TYPE (INLET/OUTLET)
1	FNPT
4	MEDIUM PRESSURE
5	HIGH PRESSURE
7 8	O-RINGS
00	BUNA-N
01	AFLAS®
02	VITON®
05	EPDM
08	POLYURETHANE
11	FFKM <i>(CONTACT PREMIER FOR PRICING)</i>
12	NITRILE, LO-TEMP

MODIFICATIONS

SEPARATE MULTIPLE MODS WITH A DASH

BLANK	NONE
AC	KRYTOX 240AC
NV	NON-VENTING
PTU	PORT TYPE UNIFORM
SM	SURFACE MOUNT

*15000 PSIG MAX INLET
THE END USER IS RESPONSIBLE TO
ENSURE ADEQUATE FITTINGS ARE USED
TO CONNECT REGULATOR TO PLUMBING*

*VESPEL® AND VITON® ARE REGISTERED
TRADEMARKS OF E.I. DUPONT DE
NEMOURS AND COMPANY. AFLAS® IS A
REGISTERED TRADEMARK OF THE ASAHI
GLASS CO., LTD*

*CONTACT FACTORY FOR MATERIAL
CERTIFICATIONS.*